

WAT-902H3 ULTIMATE 1/3" Multi Function · High Sensitivity Camera

NIR visibility with full camera control



Key features

- Min. illumination 0.0002 lx. F1.4 by NIR sensitive CCD sensor and our unique image signal amplifying circuit
- High quality image without noise under poor light condition
- Signal amplification level configurable up to 60dB and suitable for moving object in low light condition
- Electric iris, electric shutter, AGC, MGC, BLC and gamma
- Adjustable back focus CS mount
- Stability design housing for installation

Dimensions

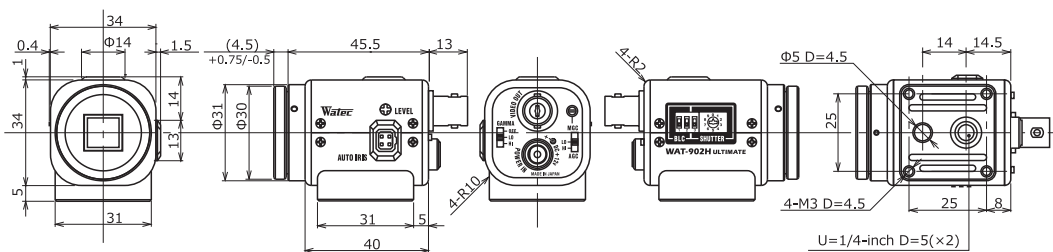

Specifications

Video standard		EIA	CCIR
Pick-up element		1/3 inch interline transfer CCD image sensor	
Number of effective pixels		768(H) × 494(V)	752(H) × 582(V)
Unit cell size		6.35µm(H) × 7.4µm(V)	6.5µm(H) × 6.25µm(V)
Synchronizing system		Internal	
Scanning system		2:1 interlace	
Video output		Composite video, 1.0 V(p-p) 75Ω (Unbalanced)	
Resolution (H)		More than 570TVL (Center)	
Minimum illumination		0.0002 lx F1.4 (AGC HIGH=60dB, Shutter=OFF)	
S/N		More than 50dB (AGC OFF=5dB, γ=1.0)	
Function settings		DIP Switch	
AE mode	Fixed	1/60, 1/100 sec.	1/50, 1/120 sec.
	EI	1/250, 1/500, 1/1000, 1/2000, 1/5000, 1/10000, 1/100000 sec.	1/50 - 1/100000 sec., 1/120 - 1/100000 sec.
AGC	ON	5 - 32dB (LOW), 5 - 60dB (HIGH)	
	OFF	-	
MGC		5 - 60dB	
Gamma characteristics		γ≈0.35, 0.45, 1.0	
Video level		100IRE	
Noise reduction		-	
Wide dynamic range		-	
Lens iris		Video / DC (EIA), Auto-select	
Back light compensation		BLC	
White blemish correction		-	
Sharpness		-	
Defog		-	
Digital zoom		-	
Privacy mask		-	
Mirror image		-	
Freeze		-	
Motion detection		-	
Neg.image		-	
Interface		BNC (Composite Video), Power in, Auto iris	
Power supply		DC+12V±10%	
Power consumption		1.26W (105mA)	
Operating temperature		-10 - +40°C	
Storage temperature		-30 - +70°C	
Operating / Storage humidity		95% RH or less (Without condensation)	
Lens mount		CS mount (Back focus adjustable)	
Weight		Approx. 98g	
Accessories		WPDC12 (DC plug), AIG-G (Iris plug), Hex. Wrench	

